



January 2026

THE HEAD OWL HOOTS

Burnell Breaker

HAPPY NEW YEAR – 2026 !!!

The new masthead for the Owl Car is above, premiering with this issue. This incorporates the new branding the NMRA introduced at Trainfest along with keeping our original masthead. We will be working to update the balance of our items to reflect the new national branding, with our current logo.

IT'S ELECTION TIME! We have an election for one board member position this year. The ballot and biography of our incumbent board member, Tim Koch, is included in this issue. You can scan or photograph the ballot. Then, follow the instructions on the ballot for mailing or emailing. The ballot **MUST** include your name and NMRA number. Our nominating/election committee of Dave Nelson, Dave Poquette and LaRoye Chisley will then be able to tally up the votes. Next year, the Superintendent, Assistant Superintendent and another Director at Large position will up for election.

Train School is Saturday, January 10 at the New Berlin Library Community Room. All the instructors from the 2025 School are returning for the 2026 School. We are encouraging attendees to bring their models, items and/or questions for the instructors and to be prepared to work with the instructors to address the issues they have.

February 21-22, 2026, is the Mad City Train Show presented by the SCWD at the Alliant Energy Center in Madison. Information regarding the show is in this month's newsletter. Arrange to carpool with others and enjoy their show. Bus trips to this and other places are not likely to happen again as the costs of renting the buses has gone up dramatically over the past years. Hopefully the weather will cooperate for all to go safely.

Our March 21 meet will be a layout tour event on our way to the Schlesingerville to Slinger Historical Museum after visiting model railroads north of Milwaukee on our way to Slinger. We will not have a contest at this meet, but hopefully we will have some CN and W&S railfanning at the depot as well as exploring the displays and model railroad. Hopefully, there will be also a local railroad-related clinic. More news regarding this meet will be in the February Owl Car.

Our final event of the season will be our annual meeting and election results on May 2 at the New Berlin Library Heritage Room. It was originally scheduled for late April but there was a conflict with using the rooms at the Library.

WE'LL SEE YOU AT TRAIN SCHOOL,
JANUARY 10!!!

MODEL RAILROADING IS FUN!!!

Burnell

Upcoming Division Events:

Board of Directors Meetings

January 14 7:00pm
Zoom

Mad City Train Show

Saturday and Sunday
February 21 - 22
Alliant Energy Center
Madison, WI

A Look at Model Railroad Clubs in Southeast Wisconsin

Lucas Iverson
Trains.com

Milwaukee and model railroading share deep, historic ties. Model Railroader Magazine, Wm. K. Walthers, Inc., and the National Model Railroad Association all had their humble beginnings in the beer city. This rich heritage has fostered a healthy and diverse group of model railroad clubs throughout Southeast Wisconsin that are still active today.

Finding these clubs can sometimes feel like searching for a needle in a haystack. With assistance and insight from the Wisconsin Southeastern (WISE) Division of the Midwest Region (MWR) of the NMRA, we've compiled a list of the model railroad clubs in Southeast Wisconsin; Kenosha, Racine, Walworth, Washington, and Waukesha counties highlighting what they offer for visitors or prospective members. If you know of a club not on this list, please leave a comment and we'll update this list.

<https://www.trains.com/mrr/beginners/model-railroad-clubs-in-southeast-wisconsin/>

Tim Koch Candidate for Director at Large



My name is Tim Koch. I'm married with one son and currently live in Slinger. I am employed as a mechanical engineer. I received a train set at age 3 and have been a Model Railroader ever since.

I grew up attending train shows and other WISE division events with my grandpa, dad, and uncle. In 1982, I started attending shows as an exhibitor with my grandpa and the WISE Division's HO track and later with my family and a few friends, we started our own group, Rusty Rails. I have been an exhibitor at every Trainfest that has been held since 82.

In 1985, I became an official NMRA member (so I could attend the conventions) and had remained a member until the early 90's when I moved out of the WISE division area to attend school. I later moved back into the area and joined again in 2010.

Currently my spare time is split between Rusty Rails, building a home layout based on the Milwaukee Roads Racine and Southwestern line, and restoring a 1946 Ford truck.

A couple of years ago, I volunteered as a Director at Large because I wanted to help the Division re-build and ensure it would be around for years to come. I'm running for re-election to continue this work.



Wisconsin Southeastern Division / Midwest Region
of the National Model Railroad Association

2025-2026 Schedule of Events

SATURDAY, September 13, 2025 - 9 AM to 3 PM

MODEL RAILROAD RETREAT - St. Paul's Lutheran Church

NON-MEMBERS \$5.00

8760 - 37th Avenue, Kenosha

SATURDAY, October 18, 2025 - 1 PM

MONTHLY MEET - New Berlin Public Library Community Room

FREE ADMISSION (*Contests, Clinics, Bring & Brag, Layout Tour*)

15105 Library Lane, New Berlin

SATURDAY & SUNDAY, November 1-2, 2025

TRAINFEST - Baird Center, Milwaukee

EXTRA FARE EVENT

SATURDAY, January 10, 2026 - 1 PM

TRAIN SCHOOL - New Berlin Public Library Community Room

FREE ADMISSION

Learn about this great hobby and all it offers from local modelers.

Stations will be set up to discover different aspects of the hobby.

SATURDAY & SUNDAY, February 21-22, 2026

MAD CITY TRAIN SHOW - Alliant Energy Center, Madison

EXTRA FARE EVENT

SATURDAY, March 21, 2026 - 1 PM

MONTHLY MEET - Schlesingerville to Slinger Historical Museum

FREE ADMISSION (*Contests, Clinics, Bring & Brag, Layout Tour*)

414 Kettle Moraine Drive S, Slinger

SATURDAY, May 2, 2026 - 1 PM

MONTHLY MEET and MEMBERSHIP MEETING -

New Berlin Public Library Heritage Room

FREE ADMISSION (*Contests, Clinics, Bring & Brag, Layout Tour*)



wisedivision.org

trainfest.com

BRING & BRAG about your recent acquisitions, layout progress or rail adventures at the Meets!

Division Video Library

A reminder for everyone that the Division's Video Library is available for members to checkout DVDs.

As I stated after the Division went inactive, I cannot do both jobs of being the Interim Superintendent and Video Librarian, bringing and managing the Video Library at our meets. If you would like to checkout any DVDs, look at our catalog on wisedivision.org and contact me with the number and title of the one(s) you would like to view. I will bring them to our next meet or you can pick them up at my business. The DVDs are currently stored in my company's warehouse in Caledonia.

If you are interested in taking over the Video Library, contact me. It's an easy job, where you need to bring the Video Library to our meets and manage the checking out and receiving of them from the members.

Burnell Breaker
brbreaker78@gmail.com
wisenmra@gmail.com
262-939-9193

Membership Directory

We have not updated our Membership Directory in over a decade. The information in this directory is vital to the ongoing revitalization of the Division.

As your new Layout Tour Chair, updating this document is my priority. With the information contained within its pages, we will be able to foster camaraderie and the sharing of ideas and expertise that is a key to a thriving organization and something that is greatly needed in the Division.

My plan is to send out a form by email, in the new year, asking for your contact information and details about your layout and other model and prototype interests. Please consider responding to my request. The Division is moving in a new direction, and this directory will be an essential part of this revival.

David Mielke
Layout Tour Chair
mielkemanor@att.net

A Note from the Editor:

The New Year is full of resolutions; lose weight, exercise more or, a favorite amongst model railroaders, spend more time on that layout. While you're at it, add to your list of resolutions to submit articles and photos. And remember that I am always looking for ideas as to what you want in the Owl Car.

Remember that the deadline for the February issue is the 20th of January. So, keep this deadline in mind and send your ideas, articles and photos to the Owl Car to cindy.m.mielke@gmail.com.

Your Editor
Cindy Mielke



Annual Train Show
Jan. 17 - March 22, 2026

All-Scale Train Show
Sat. Jan. 31 & Sun. Feb. 1, 2026
9am - 4pm
last admission at 3pm

Steampunk Faire
Sat. March 7, 2026
9am - 4pm
last admission at 3pm

www.mitchellparkdomes.com

524 S Layton Blvd. Milwaukee, WI 53215
414-257-5600



Clinics

I'm looking for Clinics for our 2025-2026 Season

by **David Nelson**

Thank you to all who presented clinics to the WISE Division this last year; it is greatly appreciated by me and by all our members. I was especially pleased that we were able to show three full-length clinics at our February meeting -- seemed like the good old days of the WISE Division! I hope we can continue this trend next season. I can be reached at engine1385@aol.com if you have a clinic idea for us.

As always, special thanks to David Rohr, our Chief Clerk, for his great work at being our "A/V Guy".

At that February meeting I mentioned something that I'd like to repeat here. As spring and summer approach, we are entering the prime "railroad convention/model train convention" season. If you belong to a railroad historical society and go to their annual meets or go to NMRA or toy train collector or gauge-specific regional or national conventions (such as 2025's N Scale Enthusiasts convention in Kansas City, or the TCA convention in Jacksonville FL) please consider giving us a 15-minute (or so) report, hopefully complete with photos of both prototype trains and models on display or layouts on tour.

I'd like to put them all together into one Saturday meet devoted to these conventions. I'd particularly like to see coverage of the NMRA National in Novi (near Detroit) Michigan. I know I will be at the C&NW Historical Society convention in Des Moines/Boone this May, but I'd also like to see coverage of the Soo Line Historical group's meeting at the Wisconsin Dells, Milwaukee Road, Great Northern in the Twin Cities, Burlington Route in Marion IL (a joint meet with the MoPac and C&EI groups), or other railroad historical society meet, or perhaps the National Railway Historical Society's national meet in Lansing Michigan.

I'd also include visits to any of the many towns and cities that have "railroad days" type civic events. It would be great if we had so many presentations that they have to split into two different monthly meets but for now I'll be happy if we can really fill one month's meeting with those presentations.

Achievement Program Awards for 2025

A lot of modeling towards Achievement Program Awards was done in 2025.

- Bryan Wickman achieved an AP award in scenery.
- Mark Willmering achieved merit awards for his 50' bridge and a rail car float. He also achieved AP awards for Electrical, Volunteer, and Dispatch.
- Ray Meyer achieved an AP award for Motive Power as well as becoming a Master Model Railroader.

Congratulations Bryan, Mark, & Ray!!

Building a CNW Sand Tower

Dave Poquette

Back in 2021, my wife and I moved into a house within the Milwaukee city limits. Fortunately, our house is located 1.5 blocks from the former CNW mainline which is now a bike path (Oak Leaf Trail). However, my previous layout was not able to be moved. After much thought of what layout I should build, I settled on modeling the engine facilities at the CNW Lakefront in Milwaukee 1938 (this location is now present-day Summerfest). Since this layout is smaller than I previously had, I would be able to model the area as closely as possible and with more features.



Looking north at the Lakefront Engine Facility in 1949. The sand tower is in the background.



1952 view of the sand tower

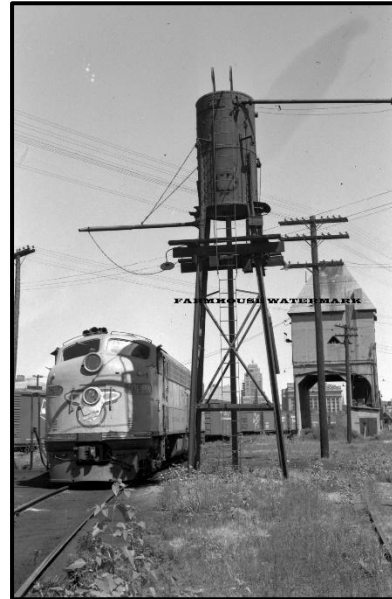

This was taken in 1966. Notice only one spout exists

I decided to start with the sand tower. I started with Walthers' Sanding Towers and Drying House kit (933-3182). The kit includes sand towers for both steam era and diesel eras. Since my layout is set in 1938, I started with the steam era. The tank support for the steam era sand tower was vertically straight up and down. I had to rework the supports.

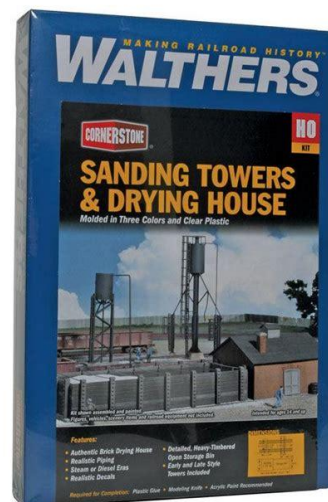



Using the sand tank's dimensions of being 10' tall, I figured out how tall the structure should be. The tank was built per the instructions. Any flat spots on the tank that were not used were filled in and sanded with

Tamiya modeling putty to make it round. The pulley brackets, spouts and spout bases were glued to the tank as per the instructions. I used .005" styrene to create 2 patch-like features on the tank as shown on the 1966 photo. I added the pull-cables to both spouts. This was done using thread and a nut-bolt casting. Rivet details were also added. The platform located on the lower right side of the tank was not added to my structure as it seemed to have been added when the second spout was removed sometime between 1952 and 1966.



The tower support was made from .060" I-beam styrene. Using the photo from 1966, it looks like the I-beam was bent. I cut each leg to length, then cut each 4' 9" off each piece. I glued the short section to the

tank to form a square. I then filed an angle on the remaining lengths and glued them back together so that it looked like it was bent. .010" x .030" styrene was used for wind bracing.

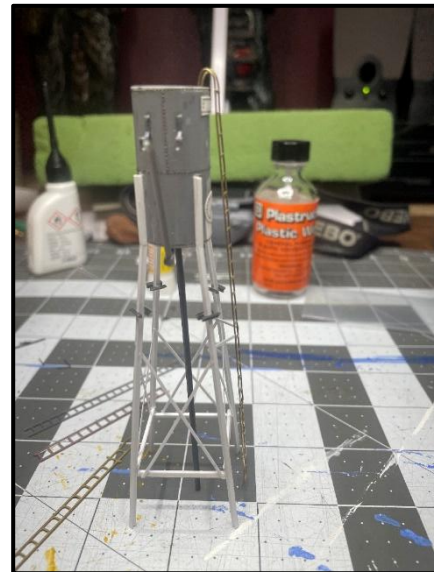

The wood platform was created from 2x8 strip wood. I could only go by what I see in the pictures. It is unknown why the wood platform was installed and the purpose of the wood boxes. I couldn't

see how the platform was held up so I used L styrene to form a brace that I think would have been used to hold the platform up. I added Tichy Nut bolt washers to show that holes were drilled into the I-beams.

2 brass Train Order, 6014, signal ladders from Tomar Industries were used for the ladder. I cut the very top rung at the top of one of the ladders so I could bend the rungs into a "U" so that it could be placed into the top of the tank. I cut the second brass ladder to length, and I soldered the two ladders together. Holes were drilled into the top of the tank for the ladder. Two, 3 scale foot pieces of .010" x .030" styrene was used as the ladder supports.

Before the wood was applied, the structure was painted grimy black. The wood was glued in place and painted rail-tie brown to simulate the creosote covered board that would have helped protect the wood from the elements. Grey chalk was applied to the entire structure.

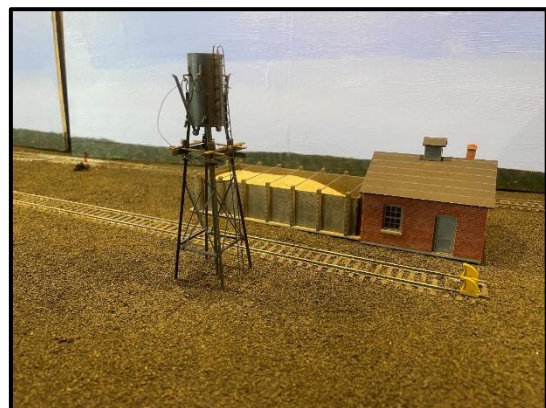

Division Leadership

Board of Directors

Burnell Breaker --- Superintendent
brbreaker78@gmail.com
wisenmra@gmail.com
 262-939-9193

Robert Niedermann --- Assistant Superintendent
rpncpa@outlook.com
 414-587-4778

David Rohr --- Chief Clerk (Secretary)
ChiefClerkWiseDiv@gmail.com
 262-783-7230

Tim Koch --- Director at Large
timkoch@charter.net

David Mielke --- Director at Large
mielkemanor@att.net

Dennis Janssen --- Assistant Paymaster
Dennisjans51@gmail.com

Committee Chairs

Gary Hendrickson --- Membership
nkpgary@gmail.com
 847-800-1380

Dave Nelson --- Clinics
engine1385@aol.com

Dave Poquette --- Achievement Program
dpoquette@wi.rr.com

Dave Mielke --- Train School/ Layout Tours
mielkemanor@att.net

Cindy Mielke --- Owl Car Editor
cindy.m.mielke@gmail.com

Mike Slater --- Social Media Manager
m Slater@wi.rr.com
 262-515-3623

Jim Hebner --- Webmaster
hebnerj@gmail.com

Open ---
 Picnic/Bus Trips ---
 Contest ---

FROM the NMRA Please Keep in Touch



Please make sure the NMRA has your current contact information. You will not be able to access the full range of NMRA benefits unless we can reach you.

- Please visit nmra.org/members
- Use your email address and password to log in.
- If you have not yet registered, or forgot your password, there are buttons for that. Take a moment to easily correct any problems.
- Once logged in, click on Member Info (top right corner).
- Make sure your information is correct.
- If not, please go to:

nmra.org/request-membership-info-changes

to submit a request for changes to be made.

Thank you!

The WISE Owl Car is published by the Wisconsin Southeastern (WISE) Division of the National Model Railroad Association (NMRA).

Subscription is free in an electronic format to all NMRA members residing within the boundaries of the WISE Division.

The Wisconsin Southeastern Division, Inc does not offer any warranties or guarantees, nor assumes any liability from the information contained in this publication.

Permission is granted to the use of news items in other publications provided credit is given to the Owl Car and author.

Trainfest and the Trainfest logo are registered trademarks of the WISE Division, NMRA, Inc.

Please send any comments, information, or editorials to Editor Cindy Mielke via email: cindy.m.mielke@gmail.com

November Board of Directors Minutes

**Wisconsin Southeastern (WISE) Division of the NMRA
Board of Directors Meeting
Wednesday, November 12, 2025
Via Zoom**

Meeting called to order by Burnell Breaker at 7:03 pm

Officers Present - Burnell Breaker (Superintendent)*
Robert Niedermann (Asst-Superintendent)*
David Rohr (Secretary, Chief Clerk)*
David Mielke (Director At Large) (Train School)*
Tim Koch (Director At Large) *

Chairs Present – Gary Hendrickson (Joined at 7:04)*, Cindy Mielke (Owl Car)*, Jim Hebner (Website)*

Guests – None * attended by Zoom

Officers Not Present – Paymaster – open position

Minutes: No changes noted from the October meeting minutes, Bob N. motioned, 2nd by Tim K., approved.

Paymaster Report: No changes noted from the October report.
Bob N. motioned, 2nd by Tim K. approved.

Membership: Gary Hendrickson –
No update. Gary talked with Lucy, and she apologized for not getting a video for us.

Clinics: Per Burnell, Dave Nelson no updates/news. We will need clinics for May 2.

AP Program: Dave Poquette – not present, no report

Layout Tours:
Dave M. is still looking for places to visit. Will likely be before each month's clinics.
Possible layouts for March are Dave's, Karl's, KMBS, Tim's, and Mark's.

Owl Car:
November issue was sent, another good issue. Dennis does not have any details on how many folks opened the email or clicked on the link to read the latest Owl Car.
Will we get a new logo, with the re-branding process? Details are still coming.

Website: Jim Hebner - not present. No report.

Train School: Dave & Cindy – Need money for supplies such as cars, couplers, etc.
May be the Region could assist. Need a flyer to include "Bring your equipment".

Model RR Retreat:
A new location is needed; a place we can charge admission and vendors.

Facebook: Mike Slater was not present. No report.

Show Schedule –

Will sell at 5 of the 6 Lionel Club's swap dates on November 16, December 21, January 18 & March 15 with 3 tables.

Maybe selling at the Metro Club's Show in Cedarburg Ozaukee show April 12, 1226. Need to sign up.

Old Business:

- **Zieger Estate** - Nothing new to report.
- **Trainfest 2025 –**
 - Feedback – lack of signage getting into the building, need more signs on the streets, parking in the rest of the Baird Center for trucks/trailers, Thursday setup ended at 7pm instead of 8pm that was published and Sommerfeld's was not happy (could have confused we were CT vs Eastern), street level entrance door issue, no suggestions from WISE was used in this year show, the award to Murry on Sunday was in a strange spot out in the entrance not in the show hall, what was the value in that award, should have re-presented the Presidents award to Burnell, move vendors to different area, it appears that GATS helped with the floor plan as it was similar to last year, no update on attendance or \$\$ made, they did add an express lane for vendor food on Sunday, tables for eating where out in the entrance, instead of by the food locations, Thomas Land was in the wrong spot (too close to the food), why did layouts need to submit name lists if the badges were generic, Vendors and layout staff should have name badge, some announcements were hard to understand, should have had Mark from WISE to help with floor plan, Sommerfeld's paid for an aisle but only had 3 aisles, not 4. Where their clinics this year?
 - Future dates are November 7 & 8, 2026 (Next year using the ABCD Halls, instead of DEF) & November 13 & 14, 2027.
- **2025-2026 schedule**
 - January 10, 2026 – NB Library – Train School
 - February 21 & 22 – Mad City Train Show
 - March 21 – Slinger Depot– Can seat 40 - 45. Could get folks from WLD (Winnebagoland Division) to attend
 - May 2 – NB Library - Annual Meeting & election results
- **\$200 Matching fund** – Need ideas for this. May be for train school or RPM? Or a picnic @ MLES, or Little Amerika (Marshal, WI).
- **John Hagen donation** – Nothing new to report.
- **Jim McKeever and Dennis & Maureen's Magazines** – All gone at Trainfest
- **2026 election** – Tim K's position would be on the ballot in Spring of 2026.
Contact Nelson and LaRoye to run the election. Need to have Dave Nelson to be the Division's historian.

New Business:

- Schulte Elementary (Racine) Music teacher name from TF booth. Wants a display.
- Dennis J. is still investigating new accounting software He is thinking of using Zoho for \$15/month which is a cloud-based system. QuickBooks Online is \$300 / year. QB desktop has been abandoned. Tim K motioned to go with Zoho, 2nd by Bob N, approved.
- Dennis also stated we could move some of the money in checking to a CD, with staggered maturity dates. Then we can gain some interest income. Motioned by Bob N, 2nd by David R, approved.
- Dennis also stated we should create a Finance Committee to create a budget.
- Need more details on the new logo design which will probably merge with the existing, new name badge design, new region bylaws.
- Storage still has 3 cartons of buildings, plaques (can be tossed), Mo Pac pins from TF 2020 (which never happened), modules w/ a turntable, Wi-Fi computer & antennas, TF banner, trains to sell (give away at train school), Woodland Scenics module. TV / sound bar & DVD player, Japanize SOO line shirts (Donate to missions in 3rd world countries).

Next Meeting:

Next BOD meeting is Wednesday, December 10 (later it was changed to December 9) via zoom. After that, will be Wednesday, January 14.

Meeting adjourned at 8:23 pm. Motioned by David M., 2nd by Tim K., approved.

Respectfully submitted by David A. Rohr, Chief Clerk.

Our Mission

The mission of the WISE Division of the National Model Railroad Association is to promote model railroading, to engage in the preservation, perpetuation and enjoyment of the hobby of model railroading, rail fanning and education generally of the history of railroading in the United States and where appropriate throughout the world and to engage in charitable work (as defined in sec, 501(c)(3) of the Internal Revenue Code of 1954, as amended) including, but not limited to providing funding to historical associations, scholarships, model railroad museums and other charitable organizations affiliated with or desiring to learn more about railroading and model railroading.

A Word about Constant Contact e-mail

Each Constant Contact e-mail includes links to update or unsubscribe your e-mail address. **Please do not use these links.** If you unsubscribe using the Constant Contact link, your e-mail address will be removed from the NMRA membership database, from the Midwest Region e-mail database and probably from your Division's records. If you get an e-mail that you don't want, just hit the delete key. Furthermore, if you use the update link, your change may not be timely posted to the NMRA membership database.

If you need to change your email address with the NMRA please follow these directions:

The direct way is to log on to the "Members" page of the NMRA website, choose the "View your NMRA membership" box on the right side of the screen, scroll down to the bottom of the page and select "Update". Enter the new email address in the appropriate box and click "Submit".



Shows and Swaps

Wisconsin and Northern Illinois

Monthly Events

Great Midwest Train Show

Dupage County Fairgrounds, Wheaton, IL
<https://www.greenbergshows.com/gmtspages/gmts>
 Jan. 4, Feb. 1, Mar. 1, Apr. 12, May 3, Jun. 7 •
 9:00am – 3:00pm

Milwaukee Lionel Railroad Club – Swap Meet

New Berlin Entertainment Center,
 16000 W. Cleveland –
 Enter from east side of building
<https://milw-lrrc.org/mlrrc-train-show-and-sale>
 Jan. 18, Feb. 15, Mar. 15, 2026 •
 8:00am – 12:00pm

Milwaukee Lionel Railroad Club – Open House

2721 S. Calhoun Rd, - Drive to back of building
<https://milw-lrrc.org/mlrrc-open-houses>
 The Club is open weekly Friday • 1:00 – 9:00
 year-round (unless major holiday)
 Winter hours Saturday & Sunday • 1:00 – 5:00
 October 4 to April 26.

Waukesha County Gandy Dancers & Badgerland S Gaugers Open House

741 N. Grand Ave., Waukesha, WI 53186
<https://www.wcgdrailroad.com/events>
 Jan. 24 – 25 (and Swap Meet), Mar. 7, May 2,
 Aug. 1, Oct 3 • 10:00am – 6:00pm

Kenosha Model Railroad Train Show (Swap)

3030 39th Ave. Kenosha Union Hall
<https://www.facebook.com/profile.php?id=10087630919326>
 Jan 4, Feb 8, Mar 8 • 9:00am – 1:00pm

LRRC SE Wis - Open House

4625 Washington Ave, Racine, WI 53405
 Upstairs of American Coin & Jewelry
<https://www.facebook.com/LRRCSEW>
 Jan. 17, Feb. 21, Mar. 21, Apr. 18
 • 10:00am – 2:00 pm

Annual Train Shows

WISE Division Train School Monthly Meet

New Berlin Public Library Community Room
 15105 Library Lane, New Berlin, WI 53151
<https://wisedivision.org/events.html>
 Jan. 10 • 1:00am
 Free Admission

Annual Train Show

Milwaukee Park Domes
 524 S. Layton Blvd, Milwaukee, WI 53215
www.mitchellparkdomes
 Jan. 17 – Mar. 22 • 9:00am – 4:00pm

Amherst & Big E Hobby Show

West Springfield, MA
<https://www.railroadhobbyshow.com/>
 Jan. 24 & 25

Arctic Run Holiday Inn Stevens Point, WI

Jan. 24 & 25

All-Scale Train Show Milwaukee Park Domes

524 S. Layton Blvd, Milwaukee, WI 53215
www.mitchellparkdomes
 Jan. 31 & Feb. 1 • 9:00am – 4:00pm

Steam Punk Faire Milwaukee Park Domes

524 S. Layton Blvd, Milwaukee, WI 53215
www.mitchellparkdomes
 Mar. 7 • 9:00am – 4:00pm

Muskego Library - Love your Library Train Event

Milwaukee Lionel Railroad Club & East Troy Trolley
 Museum
 S73W16663 W Janesville Rd., Muskego, WI 53150
<https://muskego.librarycalendar.com/event/copy-love-your-library-train-event-2526>
 Feb 7 • 10:00am – 2:00pm

Mad City Train Show

Alliant Energy Center Exhibition Hall
 1919 Alliant Energy Center Way, Madison, WI 53713
<https://www.nmra-scdw.org/mad-city-2026-.html>
 Saturday, Feb. 21 • 9:00am – 5:00pm
 Sunday, Feb. 22 • 9:00am – 4:00pm



Welcome to the NEW
WISE Division of the NMRA
 Model Trains & Railroads in Southeast Wisconsin
 You found us! You do like railroads and trains whether
 their real or models right?
 Great! We do too!



as with many new websites- a few links are not working right

[About Us](#)
[Upcoming Division Events](#)
[Owl Car](#)
[Area Model Railroad Clubs](#)

SATURDAY, October 18, 2025 - 1 PM
MONTHLY MEET - New Berlin Public Library
Community Room
FREE ADMISSION
 (Contests, Clinics, Bring & Brag, Layout Tour)
 15105 Library Lane, New Berlin

[Local Hobby Shops](#)

[Local & Not So Local Model Train & Train Shows](#)

[Area Railroad Historical Societies](#)

Model Railroad Organizations

[NMRA National Web Site](#)

[NMRA MWR Region Web Site](#)



[2026 National Convention](#)

Tacoma WA
2027 Convention

Rochester NY
2028 Convention



[Follow us on Facebook!](#)



[Follow us on YouTube!](#)



[Trainfest 2025](#)

[Wise Division Photos](#)

[WISE Division Administration](#)

[Local / Regional Railroad Museums](#)

[DVD Library](#)

[Mission Statement](#)

[Constitution](#)

[By-Laws](#)

© 2025 DIV, NMRA, Inc. All rights reserved.
 WISE DIVISION, NMRA, Inc. is a 501(c)3 non-profit organization.

The Geographical Spread of Railroads

In the United States, the railroad's expansion was dramatic and transformative. The [Baltimore and Ohio Railroad](#) recognized as the first common carrier railroad, marked a significant milestone in American railroads.

By the mid-19th century, the South Carolina Canal and Rail Road Company had introduced the first American-built steam locomotive, which further bolstered the growth of rail lines across the nation, from the East Coast to the West Coast. The Ohio Railroad and Illinois Central Railroad were among the many that contributed to the explosion of railroad mileage in America.

This expansion was not just limited to passenger trains; freight railroads became the backbone of the nation's economic growth. The Southern Pacific and Central Pacific railroads, for instance, were instrumental in establishing a reliable network for transporting goods.

The emergence of diesel-powered locomotives and the transition from wooden rails to iron and then steel rails significantly enhanced the efficiency and capacity of railroads. Innovations such as air brakes, introduced in the late 19th century, and the Pullman sleeping car revolutionized overnight passenger travel, making railroads a popular mode of transportation for long distances.

[The Staggers Rail Act of 1980](#) marked a crucial moment in modern railroad history, significantly deregulating the industry and fostering competition and innovation. This led to a more fuel-efficient and cost-effective railroad system, setting the stage for developing alternative high-speed technology and electric passenger trains.

<https://historycooperative.org/who-invented-the-railroad/>

Keep up to date on all the events in the Division by visiting the Division's website at:

[WISE Division of the NMRA Welcome](#)

or

<https://www.facebook.com/wisedivision/>

LIONEL RAILROAD CLUB
SOUTHEASTERN WI

2025 – 2026 OPEN HOUSE DATES

10/18/2025	01/17/2026
11/22/2025	02/21/2026
12/06/2025	03/21/2026
12/20/2025	04/18/2026

10:00am -2:00pm

Above American Coin & Jewelry 4625

Washington Ave., Racine

Park behind the store, Enter through the West Side Door

Admission is Free.

Donations gratefully accepted.

 **Like us on Facebook!**

“Lionel RR Club of SE WI”

Questions and Additional Information, please contact us at:

info@lionelrrclubsewi.org



(Please Turn Over for More Information!)

Outstanding Features of Our Club Rooms and Layouts

Three "O" Gauge layouts, and one "S" Gauge Layout, a Thomas-the-Tank-Engine Layout, all of which are work-in-progress status!!

- 10 x 14-foot Fastrac layout with numerous switches and wyes for operating on different routes, remote control operation, a carnival scene with operating rides and more.
- 17 x 27-foot layout that features 3 loops of track with wide sweeping curves, numerous sidings, controlled with state-of-the-art remote-control components. Scenery includes our city of Spencer, that features industrial, agricultural, and suburban areas.
- 4 x 16 layout with traditional three-rail tubular track and switches, for the pre-World War Two model train collector and operator.
- *Our Newest Addition is a 5 x 8 "S" Gauge Layout!*



(Please Turn Over for More Information!)

(turn over for Train Sale & Show Schedule)



Our 78th Year

OPEN HOUSE

Since 1947

SATURDAY and SUNDAY

NOVEMBER 29 & 30, 2025

MARCH 28 & 29, 2026

10:00 am to 5:00 pm

Parkland Plaza

2721 South Calhoun Road

New Berlin, Wisconsin 53151

(262) 754-9900

(entrance in back of building)

OPEN WEEKLY

**Open Fridays 1:00 pm to 9:00 pm
year round (unless a holiday)**

October through April

**Saturday & Sunday: 1:00 pm to 5:00 pm
call to confirm or check website**

See Many Toy Trains Running on Our Huge Layout
... Minor Train Repairs ...

OPEN HOUSE DONATION: \$2.00

**Veterans get in FREE – Scouts in uniform get parents in FREE
Children 12 and under are FREE with an adult**



Visit our Web Site
www.milw-lrrc.org

Like & Follow us on
FACEBOOK



(turn over for Club Hours)



Toy Train Sale and Show

(See below for more information)

All Gauges & All Scales

SUNDAY DATES

<u>2025</u>	<u>2026</u>	<u>2026</u>	<u>2027</u>	<u>2027</u>
October 19	January 18	October 18	January 17	October 17
November 16	February 15	November 22	February 28	November 21
December 21	March 15	December 20	March 21	December 19

BUY • SELL • TRADE
NEW • USED • PARTS

Sale: New Berlin Entertainment Center
8:00 am to 12:00 noon ADMISSION: \$4.00

16000 West Cleveland Avenue • New Berlin, Wisconsin
(Enter on east side of building)

Kids 12 and under: FREE with Adult

For More Information or Table Reservations

Robert Sobolik
(414) 483-5886

RobertDSobolik@netzero.com



TRAIN SHOW: at Club will be open by 10:00 am
2721 S. Calhoun Rd (in back of building) Donations Accepted

Visit our Web Site
www.milw-lrrc.org

Like & Follow us on
FACEBOOK 



OPEN HOUSE

January 24th-25th (& Swap Meet)

10:00 AM - 6:00 PM

March 7

10:00 AM - 6:00 PM

May 2

10:00 AM - 6:00 PM

August 1

10:00 AM - 6:00 PM

October 3

10:00 AM - 6:00 PM

**741 NORTH GRAND AVENUE
WAUKESHA, WI 53186**

FIND US AT:

WWW.WCGDRAILROAD.COM

CONTACT US:

WCGDRAILROAD@GMAIL.COM

WISE Division of the NMRA Presents
TRAIN SCHOOL

FREE ADMISSION



**SATURDAY
JAN. 10, 2026
1-4PM**

- Learn how to turn that Christmas train set into a permanent layout.
- Receive help with Track Work, Wiring, Maintenance, Scenery, DCC Programming, 3D Printing, Layout Construction.
- Assemble a Freight Car or Building Kit.



**NEW BERLIN
PUBLIC LIBRARY
COMMUNITY ROOM**
15105 W LIBRARY LN, NEW BERLIN, WI

**THE ORIGINAL 30th ANNUAL
MODEL RAILROAD
SHOW**

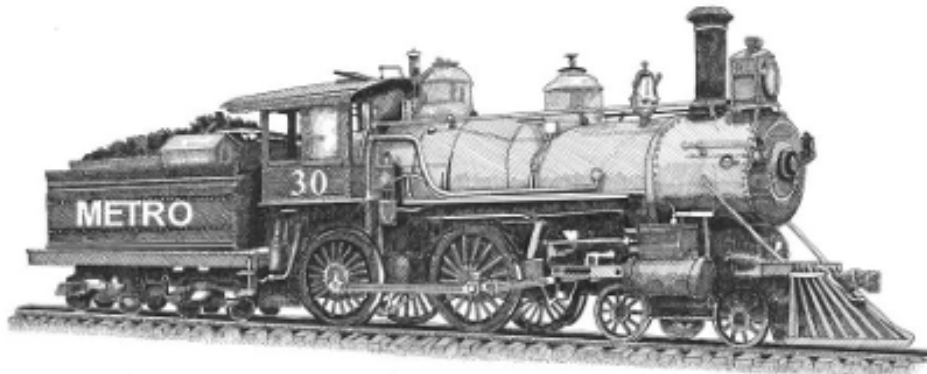

APRIL 12th, 2026

**Expo Center Ozaukee Fairgrounds
W67N866 Washington Ave, Cedarburg, WI**

9am - 4pm

- **MULTIPLE OPERATING LAYOUTS**
- **MODEL TRAIN SWAP MEET 90+ TABLES**
- **FUN FOR THE WHOLE FAMILY**
- **FREE PARKING**

**SPONSORED BY THE
METRO MODEL RAILROAD CLUB, LTD. OF
PORT WASHINGTON, WI**



**DIRECTIONS: I-43 TO HWY 60, WEST ON 60
FOR 5 MILES, SOUTH ON WASHINGTON 1.2
MILES, EAST ON CAMBRIDGE TO PARK**

**ADMISSION: ADULTS: \$5.00
CHILDREN: 12 & UNDER FREE**

**MORE INFO: <http://www.metrorrclub.org>
e-mail: jimbartelt@gmail.com
or call: James Bartelt at (262)-284-5876**



Roundhouse & Turntable Available

HO Scale 3' x 4' Module with Legs

- Walthers 110' Turntable with control box
- 4 stall Roundhouse
- Backdrop Buildings
- Freight Shed

Interested??

Contact WISE Division for more information
wisemra@gmail.com

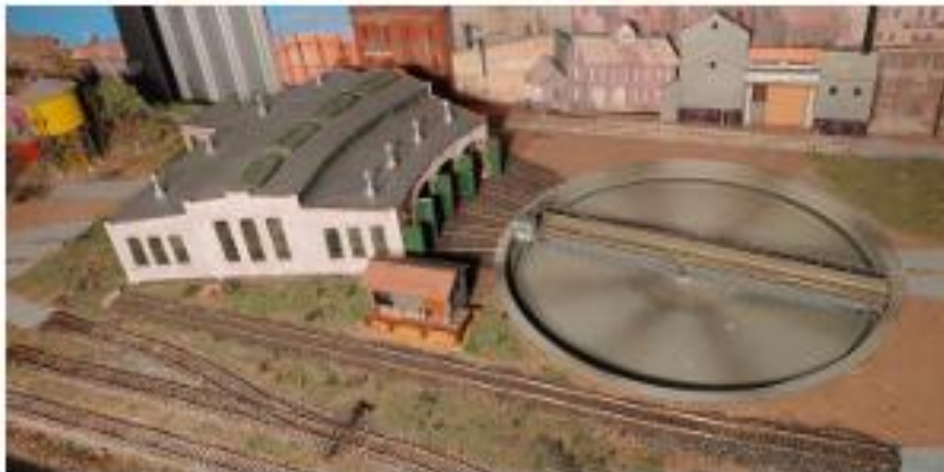

2026 WISE DIVISION BOARD ELECTION

Note: All Ballots **Must Be Mailed or Scanned/Photographed and Emailed** to:

Dave Nelson
ATTN: WISE Division Election Committee
1506 East Fox Lane
Fox Point, WI 53217
engine1385@aol.com

All ballots must be **scanned/photographed and emailed by April 15, or postmarked by April 10, received by April 15** and include **your NMRA #** for verification. Vote for no more than One candidate for the Board of Directors.

Note: **The NMRA does not allow FAMILY MEMBERS to vote, nor does the Midwest Region.**

Article IV, Membership and Dues, of the NMRA Regulations includes the following provision in Section 2: "B. Each member in the above classes, including Honorary Life Member, shall have the right to:" "4. Except for Family Members; and Sustaining and Corporate Members other than individuals, the right to vote and run for an elective office in any Region or Division of which the member is a resident member, subject to any qualification and conditions.

Name (Please Print) _____

NMRA # _____ **(required)**

VOTE for no more than ONE Board of Director candidate

_____ **Tim Koch:** Candidate for WISE Division Board of Directors

_____ Write In Candidate for Board of Directors (must be an NMRA Member):

Fold here

Dave Nelson
Attn: WISE Division Election Committee
1506 East Fox Lane
Fox Point, WI 53217

Fold here